

innr

smart lighting

BG 220

System Overview / Systemübersicht / Vue d'ensemble du système / Systeemoverzicht

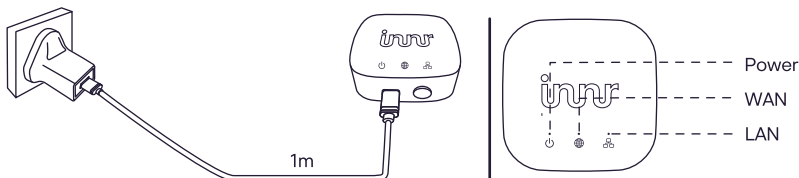

Installation / Installation

1



Download the "Innr" app and open the app.

2



Press "+" and "Add Device".

3



Scan the QR code on the bridge.

4

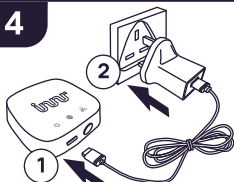

Power on the device and wait until the LED indicator blinks regularly once per second. This may take up to 40 seconds.

5



Select your WiFi network and enter the WiFi network password.

6



Follow the further instructions in the app.

Factory Reset

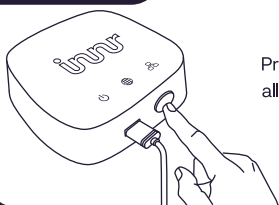

Press and hold the reset button for 10 seconds until all LED indicators start blinking rapidly, then release.

Important Safety Instructions

- For indoor use only.
- Do not disassemble the product; if any part is damaged, the product should not be used.
- For cleaning, use a damp cloth, never a strong cleaning agent.
- Keep these instructions for future use.

Declaration of Conformity for Great Britain

Hereby, Innr Lighting BV declares that the radio equipment type BG 220 is in compliance with the relevant statutory requirements.

The full text of the declaration of conformity is available at the following internet address:
www.innr.com/en/downloads

Zigbee Frequency: 2.4 GHz (2400 ~ 2483.5 MHz) - RF power: max 10 dBm

WiFi Frequency: 2.4 GHz (2401 ~ 2483 MHz) - RF power: max. 17dBm



© Innr Lighting B.V. 2021 www.innr.com